

VHT SERIES TRIPLE PASS WEATHERPROOF LOUVRE SYSTEM



Applications

The ECS **VHT** Series (**V**ertical **H**orizontal **T**riple Series louvre System) is a Triple Stage louvre system produced from Extruded Aluminium and designed to aesthetically conceal wall-mounted intake and exhaust openings, associated with air conditioning and ventilation systems whilst providing high defence against wind and rain. Often used as a decorative cladding ,the external appearance regardless whether it is used as a

façade or as a weather proof inlet .The versatility enables the system to be used in both horizontal and vertical configuration where the requirement is for a continuous effect across openings or as a screen to conceal plant and equipment ..

Aesthetic and architectural appearance:

The ECS VHT Series Louvres may be installed as individual panels both Horizontal and vertically with no limits to height or widths with unique internal drainage system. The systems exclusive configuration and spacing eliminates the possibility of see through from inside and out .

Economic:

Cost savings result from the ability to meet exact requirements with versatile standard components. The unique design and state of the art engineered machinery enable the louvre system to be manufactured in lengths of up 2000mm wide and height is unlimited, not compromising quality or structural integrity.

This benefit enables us to provide faster turnaround times and cost reductions with on site installation.

Optional accessories

Louvred Doors , bird , vermin guards ,insect mesh , blanking panels ,insulation panels and flashings ,trims are available.

Material finishes

Powder – coated / anodized

Principle of operation

The **VHT Series** louvre is a Horizontal or Vertical positioned louvre ventilation system designed to meet harsh Australian conditions with respect of wind and rain defense. The louvre utilizes its special shape and interlocking feature to achieve optimum air-flow and rain elimination whilst providing a very robust structural configuration to meet all wind load and external challenges .

Performance Data / Tech Details

The **VHT Series** Louvre system is manufactured to meet the requirements of Australian Standards AS 4740

With respect to:-

- Rain Penetration Classification
- Aerodynamic area / Pressure drop
- Wind loading

Tech Details

- Louvre Pitch: 65mm standard (can be adjusted)
- Free open area: 50%
- Blade span: 2000mm

Typical specification

Louvres shall be Element Control Systems VHT Series horizontal / vertical louvre system manufactured from , Extruded aluminum 6060 alloy . Finish can also be applied via powder coating or anodizing etc .Various warranties available

The louvre system depth shall be 125mm

Weights 16 kilograms per m2

Pressure drop/ airflow

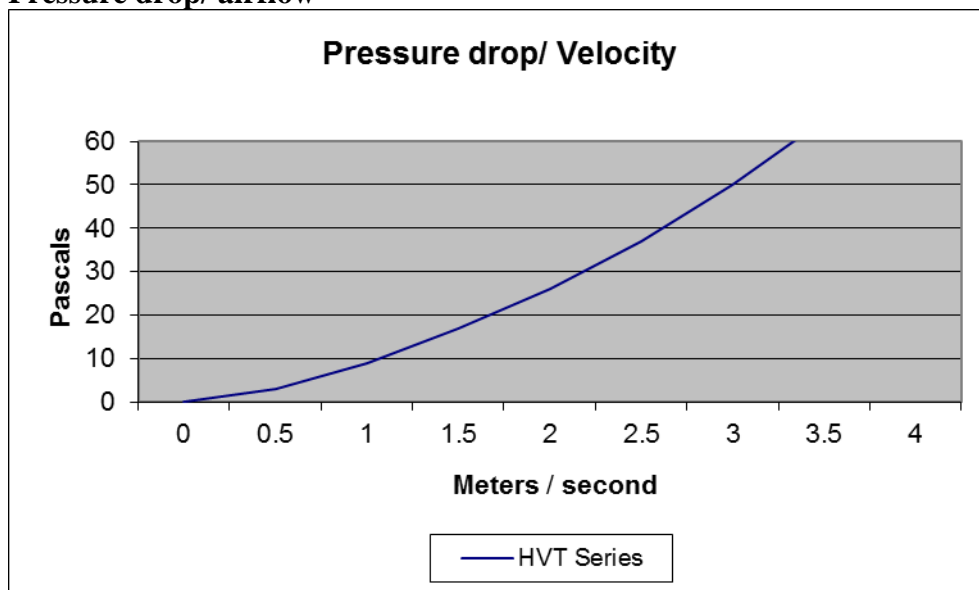

Typical Details

Horizontal applications

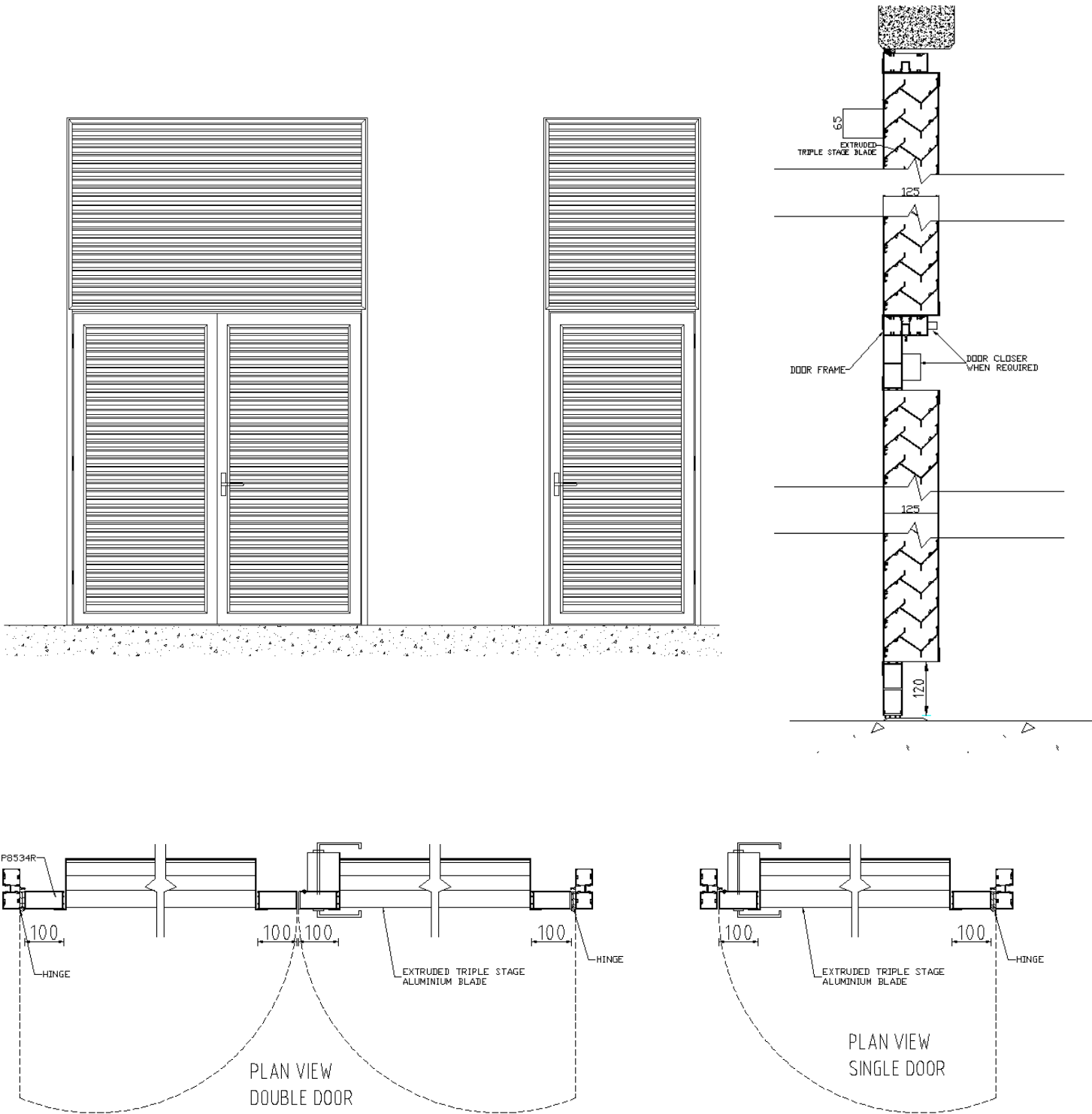

Typical Details

Vertical applications

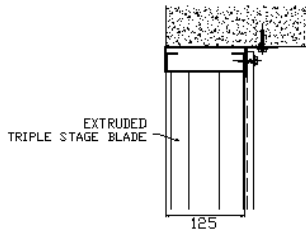

VHT VERTICAL SERIES
HEAD INTO MASONRY

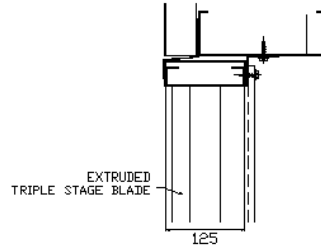

VHT VERTICAL SERIES
HEAD INTO CLADDING

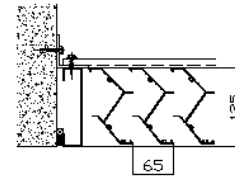

VHT VERTICAL SERIES
JAMB INTO MASONRY

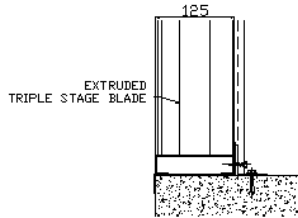

VHT VERTICAL SERIES
SILL INTO MASONRY

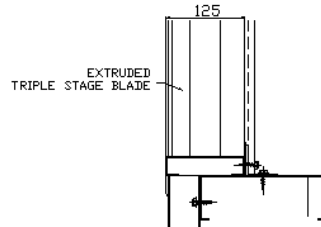

VHT VERTICAL SERIES
SILL INTO CLADDING

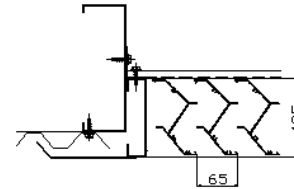

VHT VERTICAL SERIES
JAMB INTO CLADDING

Contacts

Element Control Systems

34 Wingfield Rd

Wingfield SA 5013

Ph 08 2430011 Fax 08 82430711

Web Site: www.ecsystems.com.au

Email: sales@ecsystems.com.au